

# HEAVY DUTY CONCEALED HINGE (16mm OVERLAY)



## J95-24/16T, J95-C24/16T



Nickel (NI)



Black Nickel (BN)

Wood Door Application

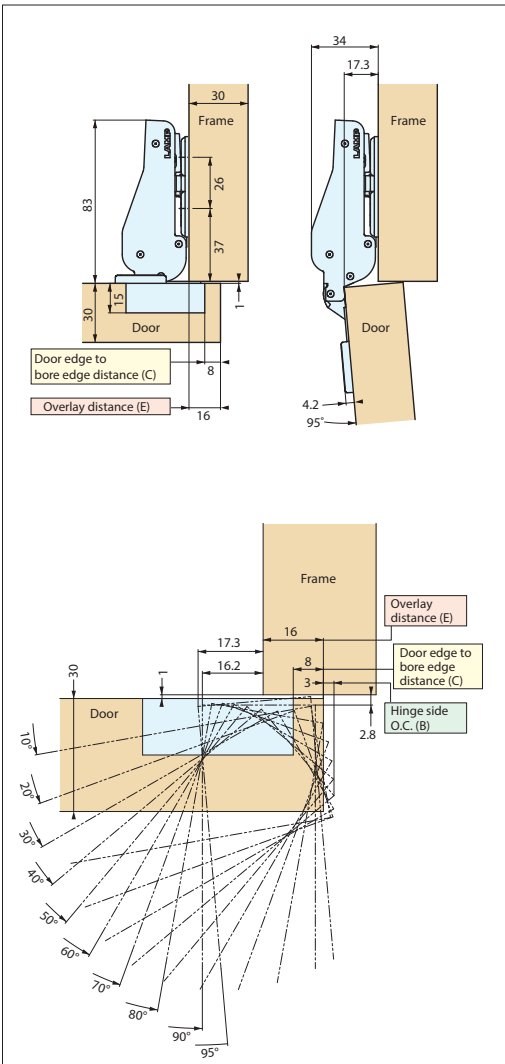

- Load capacity: 25 kg (55 lbs)/2 pcs, 40 kg (88 lbs)/3 pcs.
- Maximum door width: 800 mm (31-1/2")/2 pcs, 900 mm (35-7/16")/3 pcs.
- Clip on type for easy installation.
- 3-way adjustment with door installed.
- Requires 6 M5 or equivalent (US#10) screws: 2 pcs for each hinge, and 4 pcs for each mounting plate.
- Optional hinge cover (J95SC-16) and mounting plate cover (J95ZC) available (sold separately p.288).
- For glass door applications, see page 285.

### MOUNTING PLATE J95-P6T

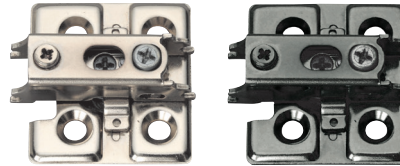

Nickel (NI)

Black Nickel (BN)

Mounting Plate sold separately. See page 288 for more details

Item No.	Finish	Weight (g)	Material
J95-P6T-NI	Nickel	94	Steel/Zinc Alloy
J95-P6T-BN	Black Nickel		

■ Door edge to bore edge distance (C) and Overlay distance (E) Table 1.

Door edge to bore edge distance (C)	3	4	5	6	7	8
Overlay distance (E)	11	12	13	14	15	16

■ Hinge side opening clearance chart Table 2.

Door thickness (D)*	Door edge to bore edge distance (C)					
	3	4	5	6	7	8
18	0.3	0.3	0.3	0.3	0.3	0.3
20	0.5	0.5	0.5	0.5	0.5	0.5
22	0.8	0.8	0.8	0.7	0.7	0.7
24	1.1	1.1	1.1	1.1	1.1	1.1
26	1.7	1.6	1.6	1.5	1.5	1.5
28	3.2	2.8	2.5	2.2	2.1	2.0
30	5.0	4.5	4.0	3.6	3.3	3.0
32	6.8	6.2	5.7	5.2	4.8	4.4
34	8.6	8.0	7.5	6.9	6.5	6.0
Hinge side O.C. (B)						

\*If the door thickness is over 30 mm (1-3/16") the door will need to be chamfered.

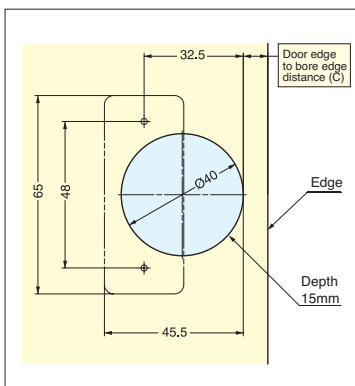

Bore Dimensions



### MOUNTING PLATE COVER (J95ZC-GR/NI/BC) and SAFETY COVER J95SC-16GR/NI/BC

Sold Separately Available in Grey (GR), Nickel (NI) and Black Chrome (BC) See p.288

Part Name	Material
Cup	Zinc Alloy
Body	Steel

Item No.	Type	Weight (g)	Box (pcs)	Carton (pcs)	Finish
J95-24/16T-NI	Free Swing	131	10	50	Nickel (NI)
J95-C24/16T-NI	Self-Closing	143			
J95-24/16T-BN	Free Swing	131			
J95-C24/16T-BN	Self-Closing	143			Black Nickel (BN)

\*Requires J95-P6T Mounting Plate (sold separately p.288).

# HEAVY DUTY CONCEALED HINGE (16mm OVERLAY)



# J95-24/16T, J95-C24/16T

HINGES

HEAVY DUTY CONCEALED HINGE (16MM OVERLAY)

Nickel (NI)



Black Nickel (BN)



Glass Door Application

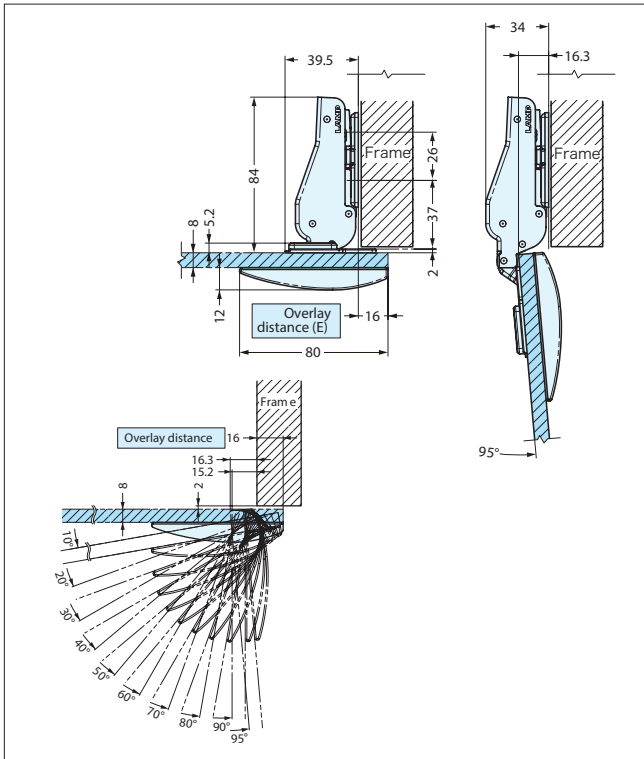

- Load capacity: 25 kg (55 lbs)/2 pcs, 35 kg (77 lbs)/3 pcs.
- Maximum door width: 800 mm (31-1/2")/2 pcs.
- Recommended door thickness: 8-10mm (5/16-3/8) for tempered glass only.
- Clip on type for easy installation.
- 3-way adjustment with door installed.
- Requires 6 M5 or equivalent (US#10) screws: 2 pcs for each hinge, and 4 pcs for each mounting plate.
- Optional hinge cover (J95SC-16) and mounting plate cover (J95ZC) available (sold separately p.288).
- Glass face plate (GH-J95FP) also available (sold separately p.289).
- For wood door applications, see page 284.

## MOUNTING PLATE J95-P6T

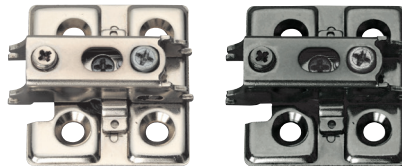

Mounting Plate sold separately. See page 288 for more details

Nickel (NI) Black Nickel (BN)

Item No.	Finish	Weight (g)	Material
J95-P6T-NI	Nickel	94	Steel/Zinc Alloy
J95-P6T-BN	Black Nickel		

■ Hinge side opening clearance chart

Glass thickness (D)	Hinge side O.C.
8	0
9.5 (3/8")	0
10	0

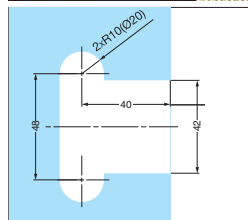
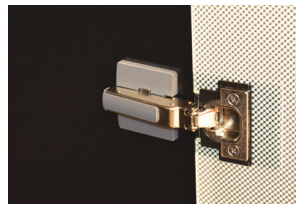

Bore Dimensions



GH-J95FP/CR/SN/BL  
Glass Face Plate  
Sold Separately  
(See p.289)

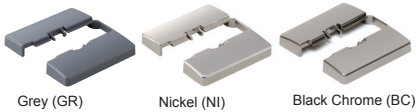

J95ZC-GR/NI/BC  
Mounting Plate Cover  
Sold Separately  
(See p.288)



J95SC-16GR/NI/BC  
Safety Cover  
Sold Separately  
(See p.288)

■ Glass thickness 8 mm

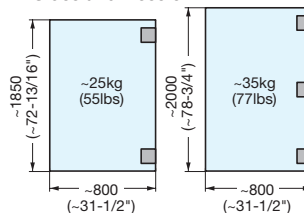

■ Glass thickness 10 mm

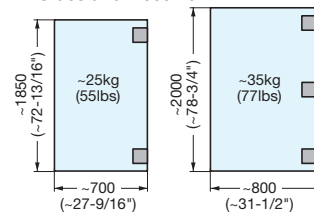

Item No.	Type	Weight (g)	Box (pcs)	Carton (pcs)	Finish
J95-24/16T-NI	Free Swing	131	10	50	Nickel (NI)
J95-C24/16T-NI	Self-Closing	143			
J95-24/16T-BN	Free Swing	131			Black Nickel (BN)
J95-C24/16T-BN	Self-Closing	143			

Part Name	Material
Cup	Zinc Alloy
Body	Steel

\*Requires J95-P6T Mounting Plate and GH-J95FP faceplate for glass door application (sold separately p.288-289).