

SLIDE BOLT

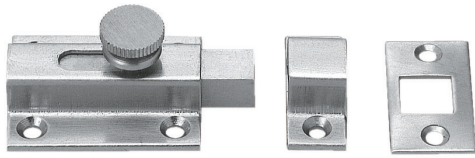

SBL



• Supplied with mortise and surface strike.

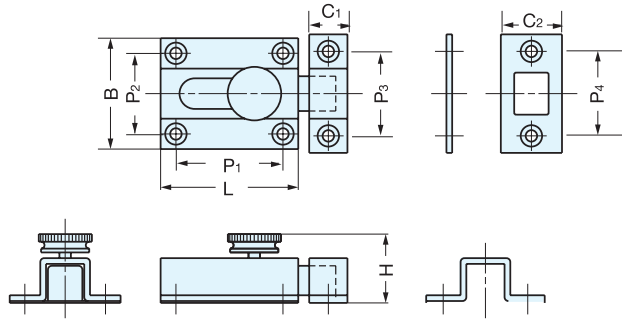

Item No.	L	B	H	C ₁	C ₂	P ₁	P ₂	P ₃	P ₄	Weight (g)	Box (pcs)	Carton (pcs)	Material	Finish
SBL-35	36 (1-27/64")	29 (1-9/64")	18.0 (45/64")	11.0	16	26.5	19	20.0	21.0	60	20	200	Brass	Satin Nickel
SBL-45	45 (1-25/32")	30 (1-3/16")	18.5 (23/32")	12.5	17	33.0	20	22.5	21.5	80	10		Brass	Satin Nickel

BARREL BOLT



BL-40, 60

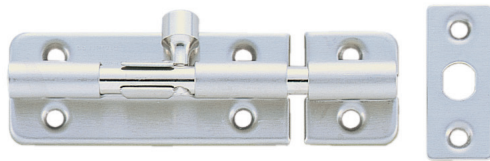

• Supplied with mortise and surface strike.

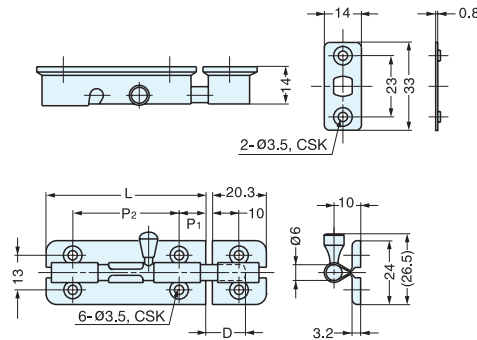

Item No.	L	P ₁	P ₂	D	Weight (g)	Box (pcs)	Carton (pcs)	Part Name	Material	Finish
BL-40	40 (1-37/64")	7.5	25	11	36	30	450	Body and Plates	304 Stainless Steel	Satin
BL-60	60 (2-23/64")	10.0	40	15	50			Bolt and Knob	Brass	Nickel

SPRING LOADED BARREL BOLT



BL-SS

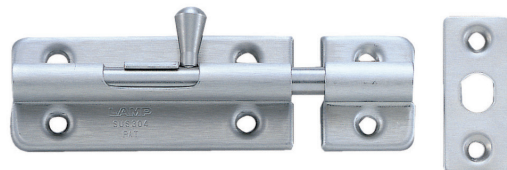

• Supplied with mortise and surface strike.
• Knob springs back into sleeve to keep bolt in locked or unlocked position.

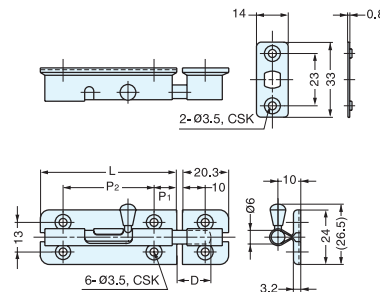

Item No.	L	P ₁	P ₂	D	Weight (g)	Box (pcs)	Carton (pcs)	Material	Finish
BL-40SS	40 (1-37/64")	7.5	25	11	36	30	450	304 Stainless Steel	Satin
BL-60SS	60 (2-23/64")	10.0	40	15	50			304 Stainless Steel	Satin