

RECESSED HOOK



NF-60



- Hook is spring loaded to retract.
- Ideal for vibration or shock applications.
- Panel Thickness: - Wood: Min. 20 mm (25/32")
- Sheet metal: 0.8~1.6 mm with optional bracket NF-50, sold separately.

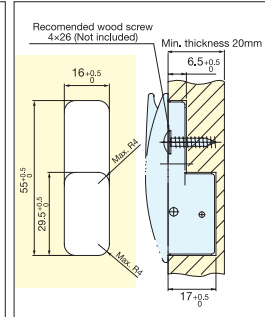
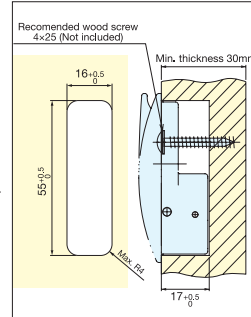
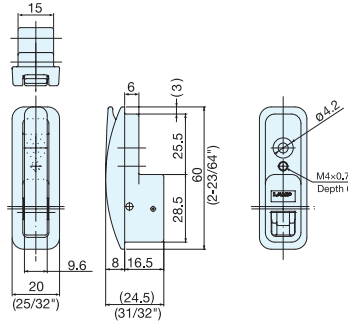

Part Name	Material	Finish
Body	Aluminum	Grey
Pin/Spring	304 Stainless Steel	Plain
Rubber	Polychloroprene	Black

Item No.	Load Capacity (kg)	Weight (g)	Box (pcs)	Carton (pcs)
NF-60	20 (44 lbs)	31	10	200

SOFT CLOSE RECESSED HOOK



NF-60D



- Hook is spring loaded to retract with a soft closing action.
- Ideal for vibration or shock applications.
- Panel Thickness: - Wood: Min. 25 mm (1")
- Sheet metal: 0.8~1.6 mm with optional bracket NF-50, sold separately.

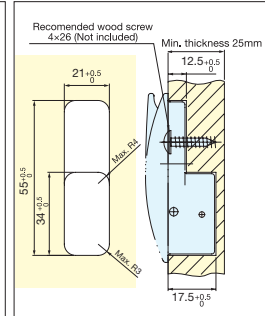
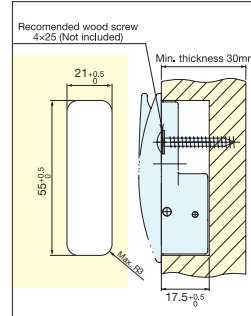
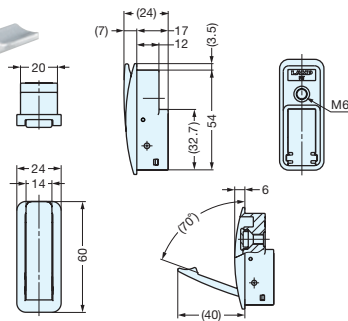

Part Name	Material	Finish
Body	Aluminum	Grey/Silver Metallic Silver
Pin/Spring	304 Stainless Steel	Plain
Rubber	Polychloroprene	Black
Rear Cover	POM	Grey

Item No.	Finish	Load Capacity (kg)	Weight (g)	Box (pcs)	Carton (pcs)
NF-60D/GR	Grey	30 (66 lbs)	49	10	200
NF-60D/SL	Silver				
NF-60D/MSL	Metallic Silver				

Bracket for sheet metal application

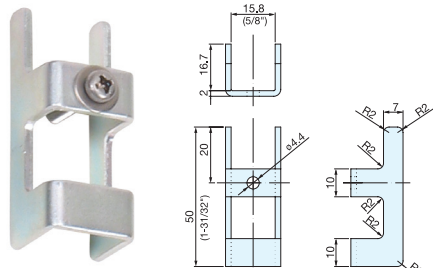

Supplied with M4x14 Stainless steel screw.

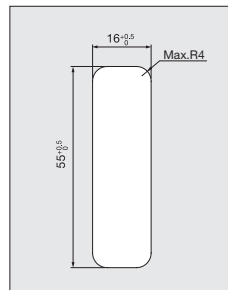

Cut Out Dimensions for NF-60

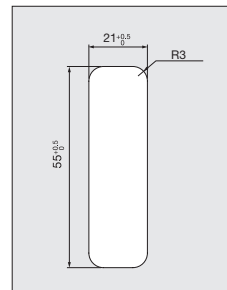

Cut Out Dimensions for NF-60D

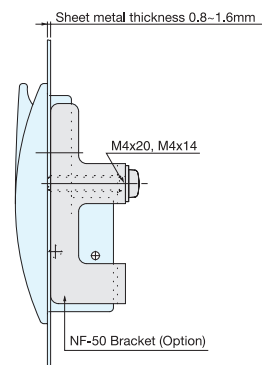

Item No.	Weight (g)	Box (pcs)	Carton (pcs)	Material	Finish
NF-50	22	20	400	Steel	Yellow Zinc Chromate